

TE WHARE O REHUA
SARJEANT GALLERY



Nō Konei | From Here

November 2024 - May 2025

Free entry

Exhibitions



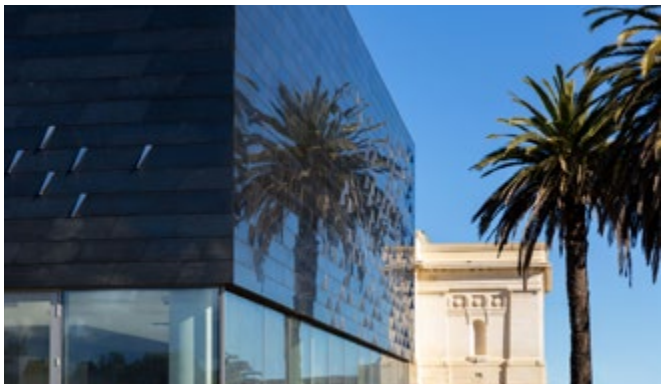

Te Whare o Rehua Sarjeant Gallery exists as a place of inspiration, connection and knowledge.

For 105 years, Te Whare o Rehua Sarjeant Gallery has stood as the cultural heart of Whanganui. Founded by Henry Sarjeant's generous bequest in 1912, and his vision of creating a gallery "as a means of inspiration for ourselves and those who come after us". Through this bequest and the gifts of subsequent benefactors, the collection has become one of national importance, numbering over 8,000 works of Aotearoa New Zealand and international art, spanning 400 years.

The gallery reconfirmed its significance to the culture and community of Whanganui in 1995 when local Iwi supported the gifting of the name 'Te Whare o Rehua' meaning 'House of Inspiration'.

After a decade away from our historic home at Pukenamu Queen's Park, we have returned following an extensive redevelopment. Design has been led by Warren and Mahoney, while the new Te Pātaka o Tā Te Atawhai Archie John Taiaroa wing incorporates visual narratives chosen through the co-design process with Te Kāhui Toi o Tūpoho. A unique element of the co-design is the overarching concept of kānapanapa, the phenomenon of light from the river environment, embodied in the new architecture.

Thanks to the collective contribution, generosity and collaboration of many, united by an appreciation of art's profound impact on society, the gallery will continue to stand confidently. This new chapter provides a restored, reimagined and co-designed gallery, a place that cares for and honours its nationally significant collection, alongside Whanganui and Aotearoa New Zealand's bicultural past, present and future.

Nō Konei | From Here
Until 11 May 2025

Nō Konei | From Here features over 200 extraordinary works from the collection, spanning four centuries of European and New Zealand art history, filling our reimagined gallery's newly expanded spaces.

The opening season of exhibitions includes a stunning survey of Edith Collier's groundbreaking works, solo projects by renowned artists Matthew McIntyre Wilson, Tia Ranginui, and Alexis Neal, as well as newly commissioned pieces from close to 20 artists from across Aotearoa New Zealand. The exhibitions traverse the gallery's spaces and collection, aiming to create conversations that span across time and media.



Andrea Gardner *Amanita* 2021. Gift of the artist, 2023.



Edith Collier *Boy Against Landscape* 1914-1915. Collection of the Edith Collier Trust, in the permanent care of Te Whare o Rehua Sarjeant Gallery.

Edith Collier *Early New Zealand Modernist* Until 16 February 2025

Adventurous and experimental, Whanganui painter Edith Collier was one of the outstanding artists of her era in Aotearoa New Zealand. This exhibition takes a fresh look at her achievement, at a time of growing international interest in the work of women modernists.

Born in 1885, the eldest child of a successful businessman, Edith studied at the Wanganui Technical School of Art and Design. With the support of her parents, she sailed to England in 1913 to pursue her career, living in London during the First World War and painting in England and Ireland. Guided by inspiring women teachers, Margaret McPherson (later Preston) and Frances Hodgkins, she developed a bold, dynamic style, based on the principles of post-impressionism.

This is the first major survey of Edith Collier's art since 1999. It is accompanied by a new book with more than 150 illustrations and contributions by 24 writers, including family members and the descendants of the people Edith painted.

Artist Projects

The origin of each of these individual projects is deeply embedded in Whanganui. Each of these new bodies of work have been years in the making, contributing to a thoughtful and connected opening season.

Matthew McIntyre Wilson *Whatu Atu, Whatu Mai* *Following the Thread of Knowledge through* *Hīnaki, Korotete, and Kupenga* Until 22 June 2025

Matthew McIntyre Wilson is a tangata tiaki of knowledge, with a practice grounded in the deep connections between whenua, whakapapa, and wānanga. The Whanganui Awa has always been more than just a physical presence for McIntyre Wilson (Taranaki Iwi – Tītahi, Ngā Māhanga); it is a living being, one that has shaped his understanding of who he is, and his relationships with uri (descendants) of the Awa. His practice reflects this understanding, especially through his work in reviving traditional Māori weaving techniques, and in particular, the crafting of hīnaki, kupenga, and korotete.



Matthew McIntyre Wilson (Taranaki Iwi, Tītahi, Ngā Māhanga)
Hīnaki 2020.



Tia Ranginui (Ngāti Hine Oneone) *Residents Only* 2024. Courtesy of the artist.

Alexis Neal
Holding Space
Until 11 May 2025

The title of this exhibition implies a sense of impermanence, a temporary occupation as well as a sense of care, to have and to hold is to cherish, to protect. As a master printmaker and self-taught weaver, Alexis Neal (Ngāti Awa, Te Ātiawa) is drawn to artefacts and the narratives they hold. Her artistic practice brings these artefacts into the light, inviting them to collaborate and inspire, to offer a voice to be woven into a contemporary context of knowledge. Neal's practice brings life to taonga tuku iho (treasure handed down) reminding us that these taonga are vessels, holding history, holding space.

Tia Ranginui
Ahi Teretere
Until 4 May 2025

Tia Ranginui's (Ngāti Hine Oneone) photographic series *Ahi Teretere* plays on the complicated and nuanced emotions provoked by returning home - a concept that for many resounds with familiarity, comfort and belonging. However, for many Māori, "home" can be a loaded ideal that does not translate into our current reality.

Ahi Teretere responds to the emotions provoked for Ranginui in returning to her papa kāinga on Te Awa Whanganui. These images engage with themes of fire and ice - where flames battle desperately against their cold, unwelcoming environments.



Alexis Neal (Ngāti Awa, Te Ātiawa) *Kākahu kōkōwai* (detail) 2024. Courtesy of the artist.



Christopher Ulutupu *Leave Room for Jesus* 2024. Courtesy of Jhana Millers Gallery.

Nō Konei | From Here

Te Pātaka o Tā Te Atawhai Archie John Taiaroa
Until 11 May 2025

Many of the contemporary pieces in *Nō Konei | From Here*, shown in Te Pātaka o Tā Te Atawhai Archie John Taiaroa, were created by artists who are alumni of the gallery's Tylee Cottage artist-in-residence programme, established in 1986. These works were made in response to time spent in Whanganui, and are shown with new works by over twenty current practitioners.

The artists chosen for this exhibition represent diverse points of view and voices, the commonality being their link to here and what the kaupapa 'nō konei' evokes for them.

Brigham Anderson (Ngāti Hauiti)
Thomas Carroll (Ngāti Maru, Hauraki, Pākehā)
Vanessa Wairata Edwards (Ngāti Tūwharetoa, Whakatōhea, Ngāti Kahu, Ngāti Kuri)
Bruce Foster
Glen Hayward
Areez Katki
James Kirkwood
Cecelia Kumeroa (Te Āti Haunui-a-Pāpārangī)
Lauren Lysaght
Catherine Macdonald
Sarah Maxey
Denis O'Connor
Prakash Patel
Ming Ranginui (Te Āti Haunui-a-Pāpārangī)
Frances Stachl (Ngāpuhi)
Lorene Taurerewa
Jade Townsend (Ngāti Kahungunu, Te Āti Haunui-a-Pāpārangī)
Chris Ulutupu
Marty Vreede
Naani Waitai (Ngāa Rauru, Ngāti Ruanui, Whanganui nui tonu, Ngā Wairiki, Rangitāne, Kahungunu, Ruapani, Tūhoe, Te Iwi Morehu)

Taumata Huarewa – Gallery Level

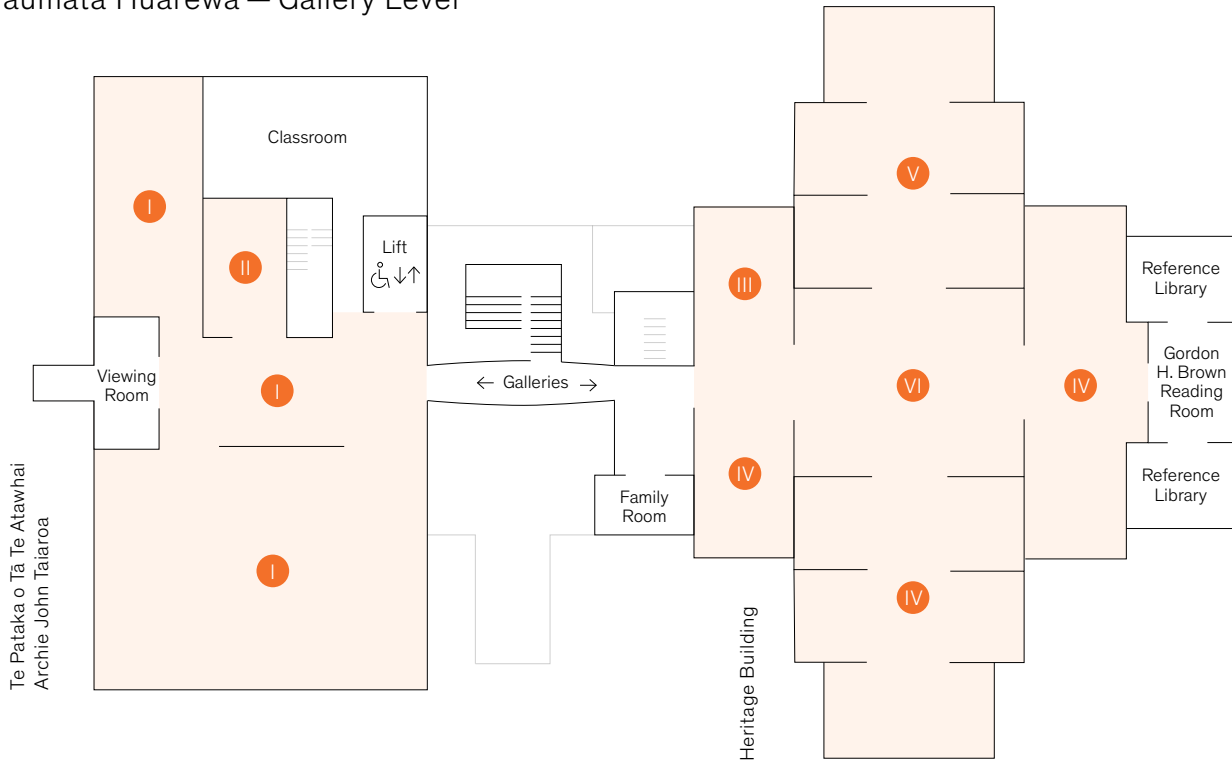

Taumata Tūāpapa – Ground Level

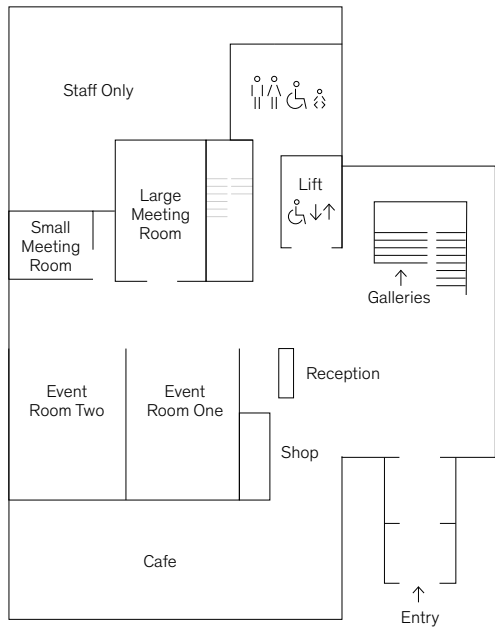

- I** **Nō Konei | From Here**
Te Pātaka o Tā Te Atawhai
Archie John Tairaroa
- II** **Alexis Neal**
Holding Space
- III** **Tia Ranginui**
Ahi Teretere
- IV** **Nō Konei | From Here**
Heritage Building
- V** **Edith Collier**
Early New Zealand Modernist
- VI** **Matthew McIntyre Wilson**
Whatu Atu, Whatu Mai
Following the Thread of
Knowledge through Hīnaki,
Korotete, and Kupenga.

Opening hours

Gallery hours

10am – 5pm

Shop and cafe hours

8.30am – 5.30pm

Open every day, excluding
Christmas Day, Good Friday
and half day ANZAC

Reference Library and Gordon
H. Brown Reading Room hours
Fridays (except public holidays)
1.30pm – 4.30pm or by appointment

Accessibility

Visit our website for information
on accessibility facilities.

Pukenamu
Queen's Park
Whanganui

06 349 0506
sarjeant.org.nz
@sarjeantgallery

Cover image: Richard Orjis *Flower Idol (Flores)* 2006. Collection of Te Whare o Rehua Sarjeant Gallery. Tylee Residency exchange, 2015.

TE WHARE O REHUA
SARJEANT GALLERY

Join & Support

Join as a Friend and enjoy a suite of benefits to enrich your art experiences. Sign up online or at reception. Become an Endowment Fund Patron and contribute to the Collection of Te Whare o Rehua Sarjeant Gallery, education programmes and ambitious exhibition projects.

Contact our Head of Development:
nicki.manthel@sarjeant.org.nz

Events

For event hire contact:
info@sarjeant.org.nz

Opening supporters



TE WHARE O REHUA
SARJEANT GALLERY
TRUST

TE WHARE O REHUA
SARJEANT GALLERY
FRIENDS

